

# Fitting Instructions

## Toe link arm- Adjustable

Code: Z390

### **Application:**

-Subaru Impreza GR,GJ My08, Subaru Forester SH

*Always refer to current catalogue for complete application listing.*

This kit is designed to lock out the existing toe angle adjuster which is prone to slippage and replace with a low compliance polyurethane bushed adjustable steel arm with lock out washers.

The low compliance bush aids with more consistent toe control during braking, cornering and acceleration.

### **Contents:**

1. 2 x M14 x 75mm Bolts
2. 2 x M14 Nyloc nuts
3. 2 x Toe link arm
4. 4 x Toe lock washers
5. 2 x Control arm tubes
6. 1 x Grease sachet

### **Fitting Instructions:**

Please read complete fitting instructions and check kit components prior to fitment. These instructions are to be used in conjunction with the workshop manual, and it is recommended that all work be carried out by a qualified technician.

1. Lift the rear of the car and with the wheels at full droop support on vehicle safety stands.
2. Remove rear road wheels.
3. Remove the toe link tie rod split pin and nut.
4. Using a suitable puller or tie rod separate remove the tie rod from the hub.
5. Remove the oe adjuster bolt and toe link arm.
6. Lubricate the bush running surface and ensure adjustable arm length is set to a similar length as the oe arm.
7. Fit the supplied toe lock washers to either side of the elongated adjuster slot, and install supplied bolt and nut.
8. Torque retaining nuts to manufacturers specs and install the supplied split pin to the tie rod end.
9. Re fit the road wheels and settle the vehicle.
10. Test drive, and re-tension all bolts.
11. Check wheel alignment, and adjust as required.
12. It is recommended to re-tension and inspect all bolts after initial settling in period of a minimum of 100kms.

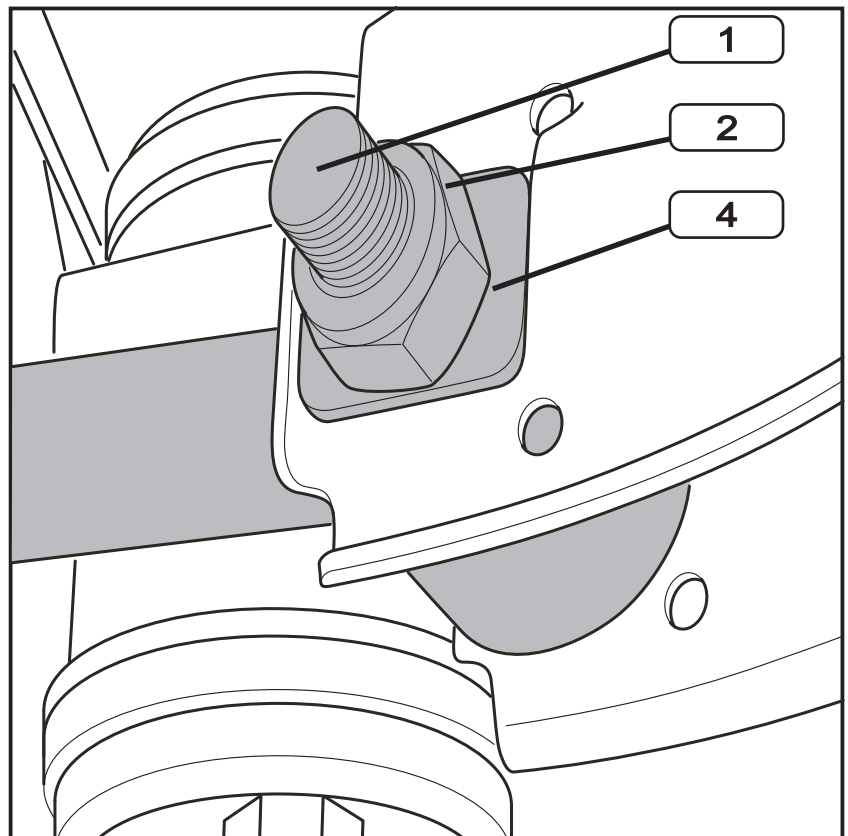
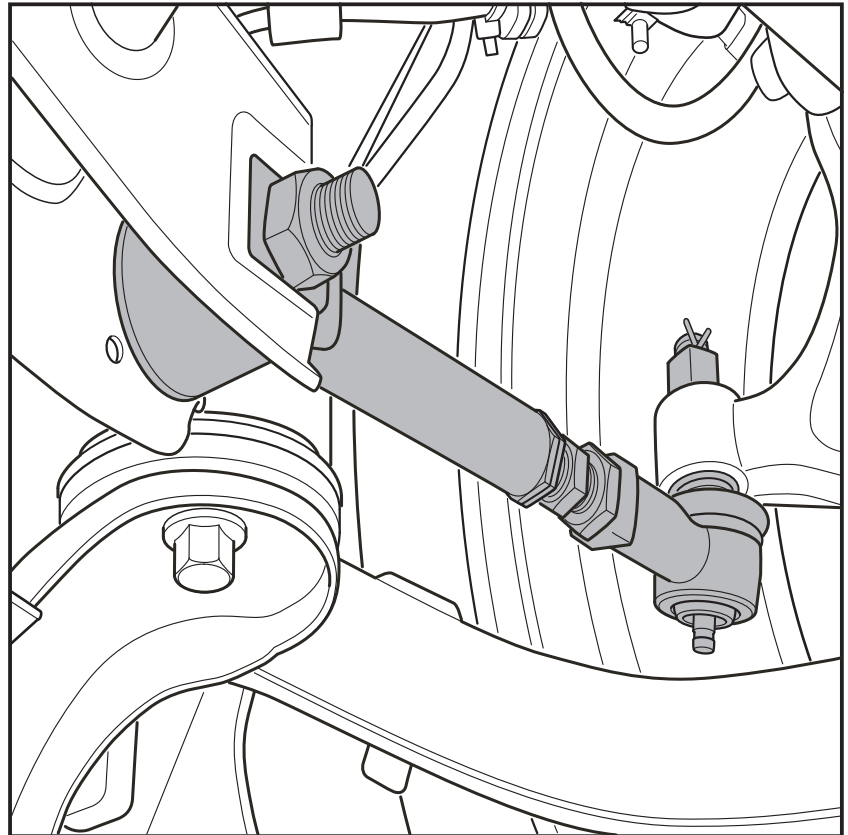

**Warning:** Please drive carefully while you accustom yourself to the changed vehicle behaviour.